WINCHESTER[®]

**IMPORTANT INSTRUCTIONS
FOR**

MODEL 1892

LEVER ACTION RIFLE



WINCHESTER[®]
Licensee
R I F L E S A N D S H O T G U N S

U.S. REPEATING ARMS COMPANY, INC.
275 Winchester Avenue
New Haven, CT, U.S.A. 06511-1970

This is one of the famous line of Winchester World Standard arms. As one of the Classic Traditions models you can expect the same quality and satisfaction as with the original historic Model 1892 introduced over 100 years ago. And as with the original, you'll appreciate its economy of design, quick handling properties and smooth functioning.

U.S. REPEATING ARMS COMPANY, INC.
275 Winchester Avenue
New Haven, CT, U.S.A. 06511-1970

Administrative Offices:
275 Winchester Avenue,
Morgan, UT, U. S. A. 84050-9333

Winchester trademarks licensed from Olin Corporation.

New gun owner's record.

Use the space below to record information about your new Winchester Model 1892 rifle.

Serial Number _____

Caliber _____

Grade _____

Purchase Price _____

Purchased From _____

Date of Purchase _____

Winchester trademarks licensed from Olin Corporation
Printed in USA. • ©1997 • KP97082.5/96504

Contents	Page
Gun safety warnings	3
General description	8
Terminology and descriptions	9
Serial number	11
Ammunition	11
Initial cleaning	12
Oiling the action	13
Operation of the hammer & safety	13
Assembly and Disassembly	19
General operation	20
Loading	20
Unloading	24
Firing	25
In the case of a misfire	28
Sight adjustments	29
Cleaning and maintenance suggestions	30
Ordering parts / service or repair	34
Questions & Winchester-Guns.com	35

MODEL 1892 CLASSIC TRADITIONS

When it comes to legends the Model 1892 stands with the greatest. It is a gun you and your family will be proud to own, shoot and enjoy for generations. We sincerely hope that you are pleased with your new rifle.

After the incredible success of the Winchester 1886 it was obvious that a smaller caliber version would be an extremely useful design. That is what led to the Model 1892. Like the 1886 it features dual, vertical locking lugs for impressive strength. But since it was designed for smaller calibers, the action could be significantly smaller and lighter, and even faster handling.

Its popularity is legendary. Admiral Peary carried one on his quest for the North Pole. It was a favorite of Annie Oakley. Not to mention the thousands of ranchers and hunters that have relied on one every day for over a century.

Today's Classic Traditions Model 1892 comes in several grades and caliber configurations. All are beautifully finished and made to the level of precision and quality that made the originals famous.

GUN SAFETY WARNINGS

IT IS ESSENTIAL THAT THESE OPERATING INSTRUCTIONS BE THOROUGHLY STUDIED BEFORE USING THIS FIREARM TO ASSURE PROPER AND SAFE GUN HANDLING. FAILURE TO FOLLOW THESE INSTRUCTIONS OR FAILURE TO OBEY ANY SAFETY WARNING MAY RESULT IN INJURY TO YOURSELF OR OTHERS, OR CAUSE DAMAGE TO YOUR GUN.

As a gun owner, you accept a set of demanding responsibilities. How seriously you take these responsibilities can be the difference between life and death. There is no excuse for careless or abusive handling of any firearm. At all times handle your rifle and any other firearm with intense respect for its power and potential danger.

PLEASE READ AND UNDERSTAND ALL OF THE CAUTIONS, PROPER HANDLING PROCEDURES AND INSTRUCTIONS OUTLINED IN THIS BOOKLET BEFORE USING YOUR NEW FIREARM.

1. Do not carry a loaded gun with a live round in the chamber while walking, running, climbing a tree, crossing a fence or anywhere you might slip or fall, drop the gun or otherwise bump or jar the gun. A gun that is dropped, bumped, or jarred with a chambered round might accidentally discharge even with the safety on, causing serious injury to you or someone else. When a round is chambered keep the safety on until you are ready to shoot.
2. Do not rely on the safety to prevent accidental discharge. Many safeties merely block the trigger and prevent firing by pulling the trigger. The safety may not prevent an accidental discharge due to dropping,

jarring, or bumping a gun.

3. Use only ammunition for which the gun is chambered as indicated on the barrel, to prevent excessive pressure and possible serious personal injury.

4. Incorrectly reloaded ammunition can cause serious personal injury and damage to the firearm due to excessive pressure. Reload only after proper instruction and in strict compliance with instruction and data contained in current reloading manuals.

5. Never point a gun at anything you do not intend to shoot. Always keep it pointed in a safe direction in case of accidental discharge.

6. Always check to ensure that the barrel is free of obstructions before loading and using the gun. If you experience light recoil or off sound, check the barrel for obstruction.

7. Before firing, clean any grease or oil out of barrel with cleaning rod and patch. Grease or heavy accumulation of oil can cause excessive pressure and result in serious personal injury.

8. Keep barrel, chamber and action free of rust. Rust in the barrel and chamber can cause excessive pressures resulting in serious injury. A rusted, pitted or eroded barrel should be replaced.

9. Use hearing protection to prevent ear damage from repeated exposure to gunfire.

10. Always use proper shooting glasses to prevent eye injury from flying particles.

11. Never carry a loaded gun in a motor vehicle or carry one into a dwelling. Always carefully unload the gun before entering a motor vehicle, a dwelling or an area such as a camp. Always point a gun in a safe direction while loading or unloading to prevent seri-

ous injury in case of an accidental discharge. Never load in the house or in your vehicle.

12. Never shoot at a hard, flat surface or at the surface of water to avoid a ricochet and possible serious personal injury to yourself or a bystander.

13. Store guns in a clean dry place out of reach of children and separated from stored ammunition.

14. Never alter any parts of your gun. Any alterations or adjustments that may become necessary to the operating mechanism should be performed by a qualified gunsmith.

15. Hunting from elevated surfaces such as tree stands is dangerous. Doing so may increase the risk of handling any firearm. Always make certain that the stand being used is safe, sturdy and stable. Always make certain your firearm is unloaded when it is being taken up and down from the stand. Always make certain that your firearm is not dropped from the stand or dropped while it is being taken up or down from the stand.

16. Discharging firearms in poorly ventilated areas, cleaning firearms, or handling ammunition may result in exposure to lead and other substances known to cause birth defects, reproductive harm and other serious physical injury. Have adequate ventilation at all times. Wash hands thoroughly after exposure.

FIGURE 1

MODEL 1892 FEATURES

Today's Classic Traditions Model 1892 is a careful reproduction of one of the original configurations of over 100 years ago.

The 1892 is a classic design, taking many of the effective and extremely popular features of the Model 1886 and incorporating them in a much smaller rifle for smaller calibers.

On the top tang you'll notice the primary difference between today's Winchester 1892 and the original. Your model features a top tang mounted safety that serves as a hammer block. The hammer is also of the rebounding type, to help prevent accidental discharge. These safety improvements give your rifle an added level of safety you will appreciate.

The two vertical locking lugs lock into matching recesses in the breech bolt for secure lockup.

The traditional open sights are easily adjustable for elevation and drift adjustable for windage.

The tubular magazine loads through the right-side mounted loading port in the receiver.

The select walnut stock is beautifully cut checkered.

The 1892 demands a high level of careful machining and hand finish. Qualities that are uncommon in most of today's mass produced guns. Qualities that take more effort but that you will appreciate for generations.

The versatile, compact action design was originally made to handle a variety of shorter cartridges. You can expect the same reliable feeding with your new Model 1892. The design of the lever and link mechanisms are both clever and unique. Other levers of the day had bulkier designs that dropped below the bottom of the receiver.

Hunters of the last century wanted the kind of metal, crescent buttplate you get on your Model 1892.

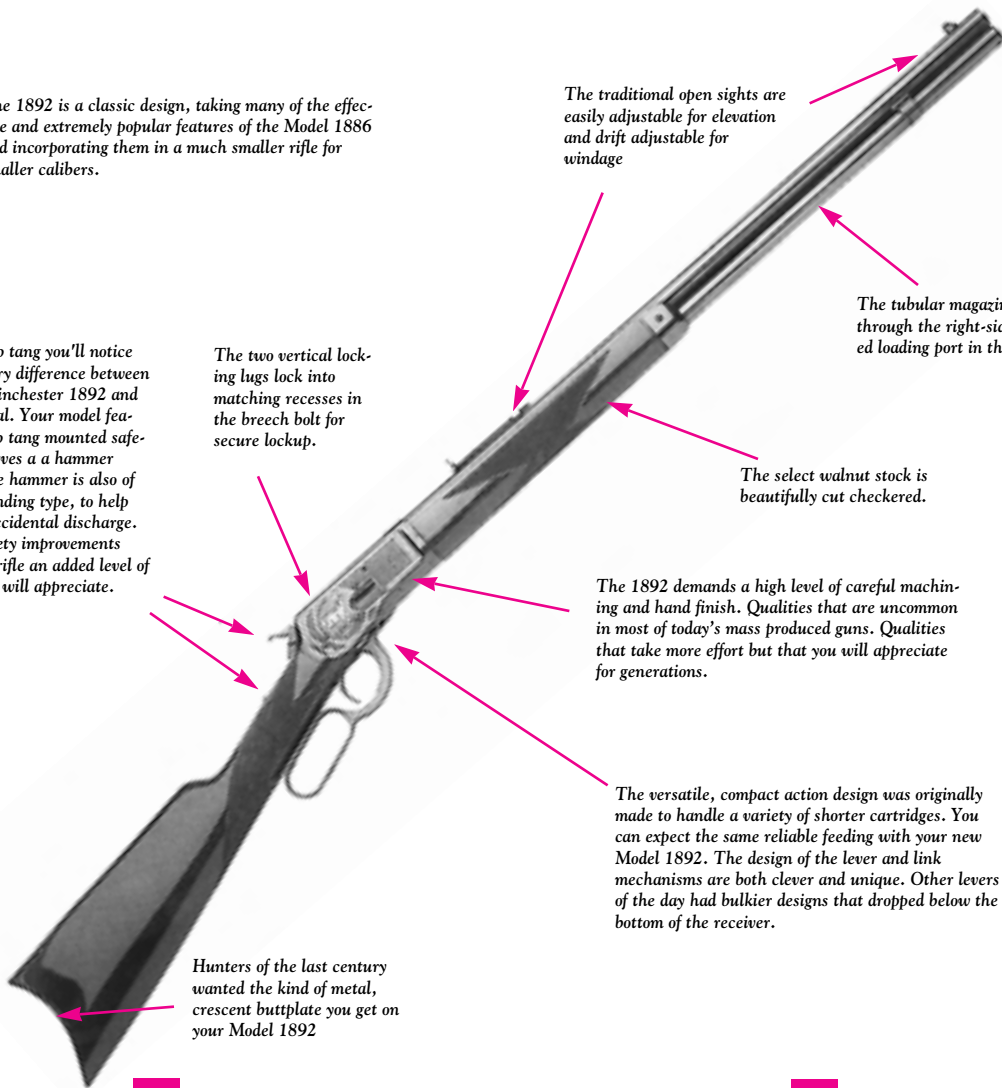
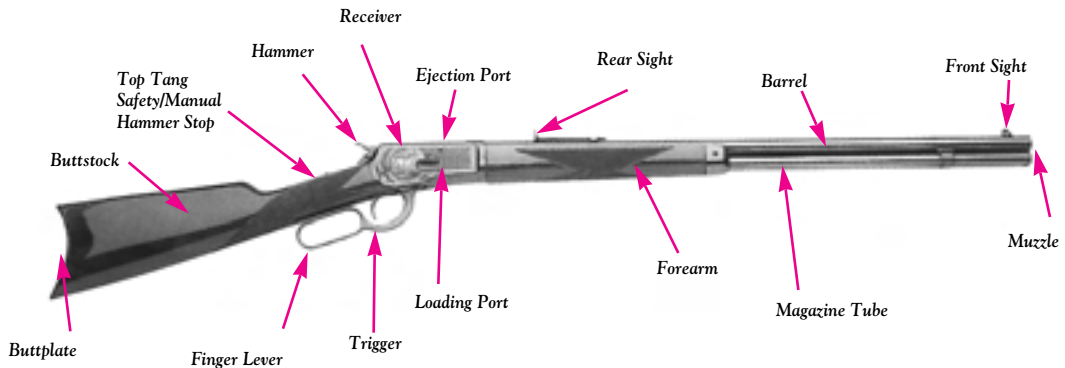

FIGURE 2A



GENERAL DESCRIPTION

Your new Model 1892 rifle is a modern version of the rifle that became so popular with tens of thousands of ranchers, farmers and cowboys late in the 19th century. With a few minor exceptions, the action is virtually identical to the way the originals were made in 1892. The primary difference is the addition of a top tang mounted safety switch for added convenience and an increased margin of safety. The 1892's safety mechanism incorporates both a hammer stop and a rebounding hammer. These advanced features move the traditional Model 1892 design to a new level of convenience and safety. These features are explained in detail later in this manual.

Figure 1 covers the general features and benefits of the Model 1892 design.

Cycling the lever smoothly moves a cartridge from

the tubular magazine to the chamber. After firing, working the lever ejects the empty cartridge nearly straight up and slightly to the right, over your head. Returning the lever upward cycles a new cartridge from the magazine into the chamber. The 1892's uncanny, reliable, smooth function made it an instant success in its day. We are sure you will appreciate its incredibly design and high level of precision as you become familiar with it by reviewing these instructions.

TERMINOLOGY AND DESCRIPTIONS.

Descriptions in this manual generally refer to the gun in the horizontal position. That is, in the normal firing position. For example, the muzzle is forward or front; the buttstock is rearward or rear; the trigger is downward or underneath; the sight is upward or on top.

FIGURE 2B



FIGURE 2C

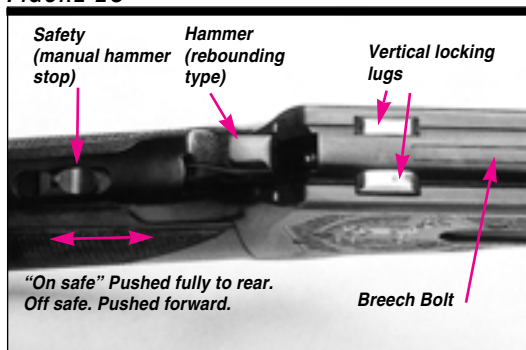

Throughout this manual the “action” refers to the mechanism of this rifle which loads and secures the cartridge in the chamber.

IMPORTANT: Refer to Figures 2A-D for general part descriptions and terminology regarding your new rifle. You must become familiar with all part names listed before proceeding with the rest of the instructions in this manual.

FIGURE 2-D

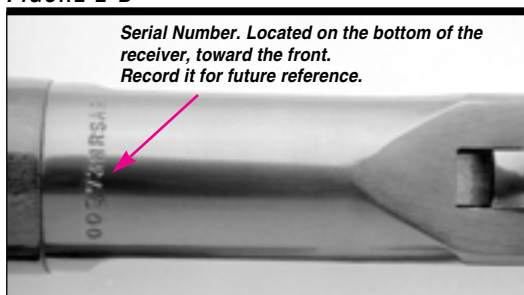

SERIAL NUMBER

The serial number is located on the bottom of the receiver, where the receiver meets the forearm (see Figure 2-D). Record the serial number at the front of this book for future reference.

AMMUNITION

Your Winchester Model 1892 is designed to shoot modern factory cartridges only. The caliber of your new Model 1892 is inscribed on the top of the barrel in front of the receiver.

MAKE SURE YOU USE ONLY THE EXACT AMMUNITION/ CALIBER AS LISTED ON THE BARREL.

Incorrectly reloaded ammunition can cause serious personal injury and damage to the firearm due to excessive pressure. Reload only after proper instruction and in strict compliance with instructions and data contained in current reloading manuals.

Winchester ammunition is always an excellent choice for your new Winchester rifle, delivering the unmatched performance and dependability you want.

DISCHARGING FIREARMS IN POORLY VENTILATED AREAS, CLEANING

FIREARMS, OR HANDLING AMMUNITION MAY RESULT IN EXPOSURE TO LEAD AND OTHER SUBSTANCES KNOWN TO CAUSE BIRTH DEFECTS, REPRODUCTIVE HARM AND OTHER SERIOUS PHYSICAL INJURY. HAVE ADEQUATE VENTILATION AT ALL TIMES. WASH HANDS THOROUGHLY AFTER EXPOSURE.

INITIAL CLEANING

Some metal parts of your new Model 1892 have been coated at the factory with a rust preventative compound. Before using your Model 1892, clean the anti-rust compound from the inside of the barrel, receiver, cartridge feed mechanism and the action/chamber areas. A high quality, light gun oil should be used to remove this compound and to give your new gun its first lubrication. Clean the barrel using a cleaning rod and patch as explained under “Cleaning and Maintenance Suggestions” found later in this manual. First lubrication suggestions are outlined below.

If your new Model 1892 is for collector’s purposes only, and is to remain unfired, it is permissible to leave the rust preventative compound in place and keep your Model 1892 in its box for maximum protection during long term storage.

FIGURE 3



OILING THE ACTION

Before beginning the first firing of your Model 1892 you should first wipe the mechanism completely clean, clean the bore and apply a few drops of quality oil on the following surfaces (See Figure 3):

- Along the breech bolt surface.
- Along the breech bolt rail surfaces.
- On all pivot points and bearing surfaces on the lever mechanism.

Avoid applying too much oil. Only a light film is necessary. Cleaning and Maintenance Suggestions should be followed before each oiling.

OPERATION OF THE HAMMER & SAFETY

Your Model 1892 features a new, innovative safety (also called a manual hammer stop) built into the top tang of your rifle, as well as a rebounding hammer design built into the hammer mechanism itself.

The Model 1892’s **Rebounding Hammer** is a safety feature designed to protect the firing pin from being struck by the hammer when the trigger is not being pulled. After firing your rifle the hammer immediately moves to the rebound position. The hammer can also be manually lowered from full cock to the rebound position. From the rebound position, under normal conditions, the hammer is prevented from moving forward and striking the firing pin. The rebound position and the safety (manual hammer stop) are intended to work together to provide protection against unintentional or accidental firing.

HAMMER POSITIONS —

The rebounding hammer on your Model 1892 has two positions as follows:

FIGURE 4

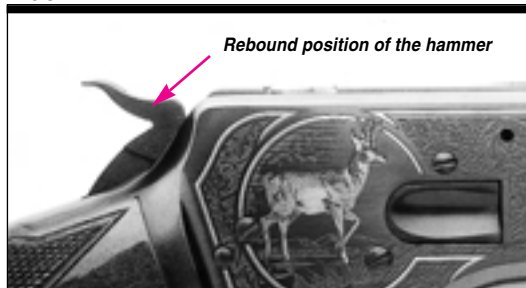

• **Rebound position.** This position (See Figure 4) takes the place of the dropped and half-cocked positions found on the original Model 1892s of a century ago. The rebounding feature of the hammer essentially eliminates the dropped position. The hammer only travels to the dropped position momentarily after the trigger has been pulled with the hammer cocked. The hammer then automatically moves to the rebound position.

THE REBOUND POSITION IS THE RECOMMENDED POSITION OF THE HAMMER AT ALL TIMES AND SHOULD BE IN THAT POSITION EXCEPT (1) WHEN FIRING IS IMMINENT (2) OR IMMEDIATELY AFTER THE ACTION HAS BEEN CYCLED.

• **Cocked position.** This is the position that the hammer is moved to when firing is imminent (See Figure 5). It is also the position the hammer moves to when the action is cycled using the finger lever.

WHEN THE HAMMER IS IN THE COCKED POSITION THE SAFETY SHOULD BE IN THE "ON" POSITION (WITH THE "S" SHOWING) UNLESS FIRING IS IMMINENT.

FIGURE 5

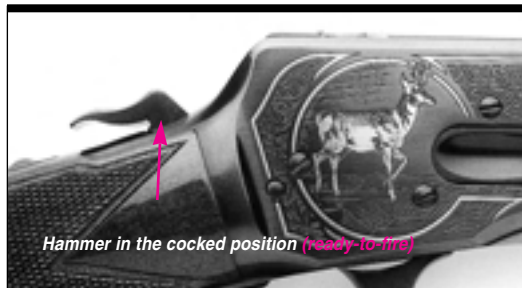

SAFETY POSITIONS —

The safety (also referred to as the manual hammer stop) is a modern feature built into the action of your Model 1892 to provide an additional level of safety. When the safety has been placed in the "on" position it serves the function of blocking the hammer from striking the firing pin. Even if the safety is on, it does not prevent the hammer from falling to the rebound position when the trigger is pulled. When the trigger is pulled — with the safety on — the hammer drops, going immediately to the rebound position without impacting the firing pin.

The safety on your new Model 1892 is built into the top tang of the receiver. The safety "switch" itself is fitted into an elongated, machined recess in the tang.

FIGURE 6A

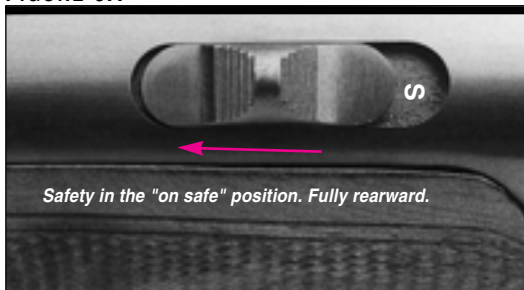

Safety in the "on safe" position. Fully rearward.

"On" Position.

When the safety is pushed all the way rearward it is in the "on" position (See Figure 6-A). In this position an "S" is visible directly in front of the safety. Moving the safety fully rearward and exposing the "S" blocks the hammer from striking the firing pin.

THIS IS THE RECOMMENDED POSITION OF THE SAFETY FOR ALL TIMES EXCEPT WHEN FIRING IS IMMINENT.

"Off" Position.

When the safety (manual hammer stop) is pushed all the way forward it is in the "off" position (See Figure 6-B). **THIS IS THE POSITION OF THE SAFETY WHEN FIRING IS IMMINENT.** In this position, when the trigger is pulled, the cocked hammer will fall and strike the firing pin. If a cartridge is in the chamber, the firing pin will strike the primer and fire the cartridge.

USING THE SAFETY —

To place the safety (hammer stop) in the "on" position: First, point your rifle in a safe direction, then place the safety in the "on" position by pulling it fully to the rear with your thumb until the red "warning"

FIGURE 6B

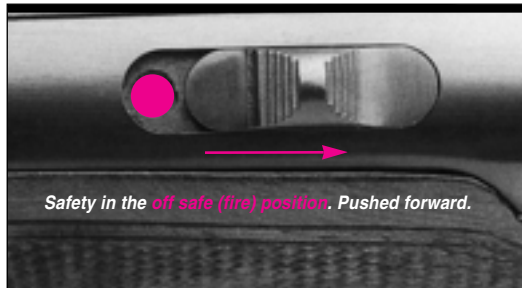

Safety in the off safe (fire) position. Pushed forward.

spot is covered by the safety and the "S" is visible (Refer again to Figure 6-A).

To place the safety (hammer stop) in the "off" position: Push the safety fully forward, covering the "S" inscribed on the rifle, and exposing the red warning dot. When the red dot is visible below the safety it is in the "off" position (Refer again to Figure 6-B). The safety can be actuated with the hammer in the rebound or cocked position.

LOWERING THE HAMMER —

At any time the hammer can be cocked either manually or by cycling the finger lever fully. Unless shooting is imminent it is important to lower the hammer immediately to the rebound position from the cocked position. To do this:

1. MAKE SURE THE BARREL IS POINTED IN A SAFE DIRECTION AND THAT THE SAFETY (MANUAL HAMMER STOP) IS IN THE "ON" POSITION.

2. Get a stable grip on your rifle with your hand in shooting position. Place your thumb on the hammer and firmly hold the hammer back slightly with your thumb.

3. While holding the hammer back, apply just enough pressure on the trigger to release the hammer

FIGURE 7

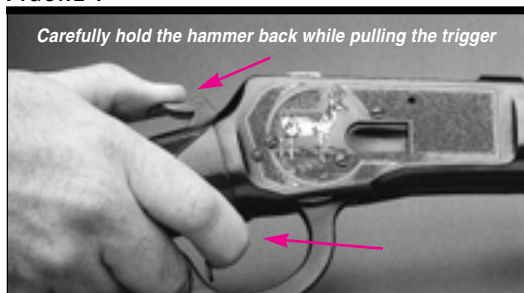
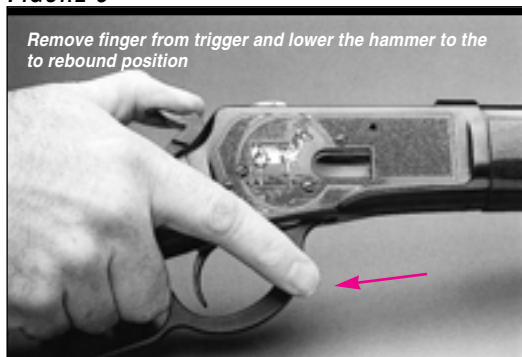

FIGURE 8



from the full-cock position (see Figure 7). Immediately remove your finger from the trigger and slowly and carefully allow the hammer to lower into the rebound position (see Figure 8).

IMPORTANT INFORMATION ABOUT THIS RIFLE'S SAFETY MECHANISMS —

REMEMBER, NEVER RELY TOTALLY ON YOUR FIREARM'S MECHANICAL "SAFETY" DEVICES.

As is true with other firearms, when the safety mechanisms on this rifle are engaged, they are designed to prevent accidental discharge. **However, these mechanisms may not necessarily prevent the accidental dis-**

charge of this firearm as a result of jarring or abuse such as occurs when a firearm is dropped.

ALWAYS ASSUME THAT YOUR GUN CAN BE FIRED AT ANY TIME, EVEN WITH ALL SAFETY MECHANISMS ENGAGED.

WHENEVER YOU ARE NOT ACTUALLY FIRING YOUR RIFLE ALWAYS BE CERTAIN THAT YOUR RIFLE IS POINTED IN A SAFE DIRECTION.

Continually be aware of the position of the safety (manual hammer stop) on your rifle. Check it both manually and visually to avoid any chance of accidental discharge. Always keep the safety in the "on" position unless you are actually firing the rifle. It is a good idea to keep the action open (with the finger lever down) at all times other than when you are in the field and shooting is imminent.

IMPORTANT: IT IS ALWAYS RECOMMENDED THAT THE ACTION BE KEPT OPEN AT ALL TIMES WHEN YOUR RIFLE IS LAYING ON ANY BENCH OR TABLE AT A SHOOTING RANGE OR OTHER FACILITY.

ALWAYS KEEP THE MUZZLE OF YOUR RIFLE POINTED IN A SAFE DIRECTION. FAILURE TO FOLLOW THE ABOVE INSTRUCTIONS COULD RESULT IN INJURY OR DEATH TO YOURSELF OR OTHERS.

ASSEMBLY AND DISASSEMBLY

Your Model 1892 comes fully assembled in the box. No assembly is required. No disassembly is required for normal maintenance.

If your Model 1892 requires disassembly for any reason (such as requiring extra cleaning after being dropped in water) it should be performed by one of

the U.S. Repeating Arms Authorized Repair Centers (ARCs). See “Service or Repair” later in this manual for details on how to obtain service for your Winchester rifle.

GENERAL OPERATION

ALWAYS KEEP THE MUZZLE POINTED IN A SAFE DIRECTION.

Prior to using live ammunition, it is essential that you familiarize yourself thoroughly with these operating instructions. Get accustomed to the feel of your new gun.

- Know the forces required to operate the action
- Know what forces are required to pull the trigger
- **ABOVE ALL, KNOW HOW TO PLACE THE HAMMER INTO THE REBOUND POSITION AND THE SAFETY (MANUAL HAMMER STOP) INTO THE “ON” POSITION.**

Throughout this manual the “action” refers to the mechanism of a firearm which loads and secures the cartridge in the chamber. If the action resists closing, do not force it. Small pieces of grit or other obstructions can make it difficult to close the action. Make sure all surfaces are clean if any unusual resistance is felt. However, remember that this is a finely fitted action purposely made with tight tolerances. This assures your gun of good part-to-part fit for many years to come and is the sign of a finely crafted firearm.

LOADING

USE THE CORRECT AMMUNITION AS INDICATED BY THE INSCRIPTION ON THE BARREL. AS EXPLAINED PREVIOUSLY,

BEFORE LOADING YOUR RIFLE MAKE SURE ALL GREASE AND OIL HAS BEEN REMOVED FROM THE BARREL AND CHAMBER, AND THERE ARE NO OBSTRUCTIONS IN THE BARREL OR ACTION AREAS.

LOADING THE CHAMBER —

The chamber may be loaded two ways. Before attempting any loading procedure:

MAKE SURE THE BARREL IS POINTED IN A SAFE DIRECTION AND THAT THE SAFETY (MANUAL HAMMER STOP) IS IN THE “ON” (SAFE) POSITION AND THE HAMMER IS IN THE REBOUND POSITION.

- Load the chamber by placing a cartridge directly into the chamber through the opened action. This is for single shot loading only with the magazine empty. To do this, open the action by operating the finger lever fully down and forward. Insert a round into the chamber then close the action.
- Load the chamber by transferring a cartridge that was previously loaded into the magazine to the chamber by operating the finger lever. To cycle the lever, pull it downward and fully forward with the fingers of your hand inserted in the finger loop (see Figure 9).

FIGURE 9

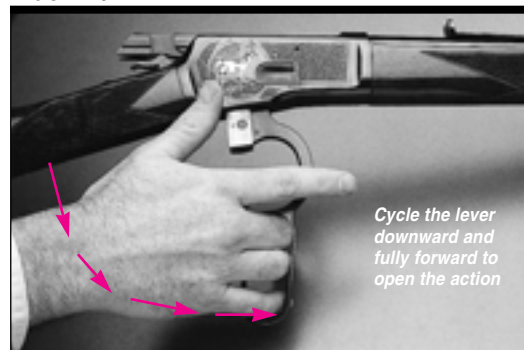

Cycle the lever downward and fully forward to open the action

FIGURE 10

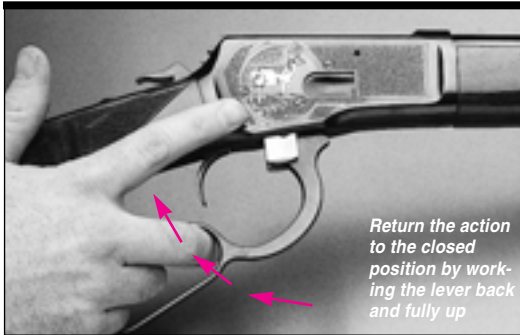

FIGURE 11A

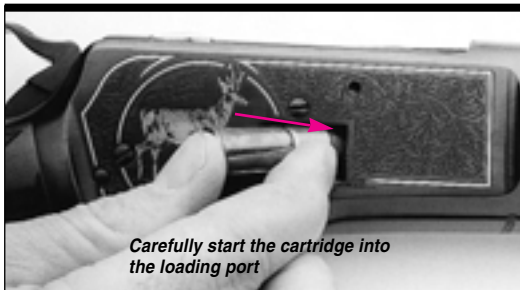
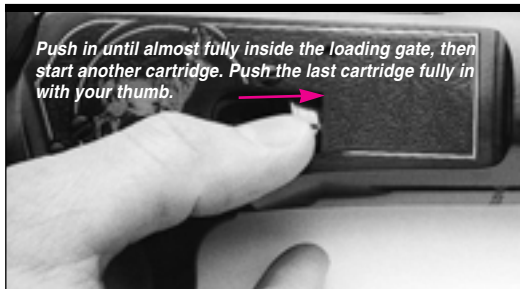

FIGURE 11B



Then return it upward to its original position (see Figure 10). Keep your fingers clear of the trigger at all times when working the lever.

IN EITHER CASE, ALWAYS FIRST PLACE THE SAFETY (MANUAL HAMMER STOP) IN

FIGURE 12



THE "ON" POSITION, AND THEN PLACE THE HAMMER INTO THE REBOUND POSITION UPON CLOSING THE ACTION.

LOADING THE MAGAZINE —

The magazine is loaded through the port on the right side of the receiver.

1. With the action closed and the safety (manual hammer stop) in the "on" position and the hammer in the rebound position, press the spring cover inward with the tip of the first cartridge until all but the rim has entered the loading port (See Figure 11A & B).
2. Then, insert the next cartridge in the same manner, pushing the preceding cartridge into the magazine.
3. Repeat this procedure with each cartridge, but push the last cartridge past the end of the spring cover, allowing the cover to snap closed (see Figure 12). Do not exceed the recommended capacity of the magazine.

BEFORE LOADING, ALWAYS MAKE SURE TO ALWAYS PLACE THE SAFETY (MANUAL HAMMER STOP) IN THE "ON" POSITION, AND THE HAMMER IN THE REBOUND POSITION.

CAUTION: ALWAYS MAKE SURE THE CAR-

TRIDGES ARE OF THE PROPER CALIBER FOR YOUR RIFLE. CHECK THE AMMUNITION DESIGNATION ON THE BARREL. FAILURE TO FOLLOW THIS INSTRUCTION CAN RESULT IN SEVERE DAMAGE TO YOUR GUN AND POSSIBLE SERIOUS INJURY TO YOURSELF OR OTHERS.

UNLOADING

Fully unloading your rifle when storing your rifle or in other appropriate situations is essential to safe gun handling.

BEFORE UNLOADING, CHECK TO ASSURE THAT THE MANUAL HAMMER STOP IS IN THE "ON" POSITION (SAFE) BY PULLING IT FULLY TO THE REAR UNTIL THE "S" JUST FORWARD OF THE SAFETY IS VISIBLE. KEEP YOUR FINGER AWAY FROM THE TRIGGER WHEN CYCLING THE ACTION.

IMPORTANT:

1. WITH THE GUN POINTED IN A SAFE DIRECTION AND YOUR FINGER OFF THE TRIGGER, SWING THE FINGER LEVER DOWNWARD FULLY. THIS WILL EXTRACT ANY CARTRIDGE FROM THE CHAMBER AND EJECT IT.

Capture (or pick up) the cartridge and return the finger lever fully upward.

2. Proceed to operate the finger lever in the same manner transferring all the remaining cartridges from the magazine to the chamber and then eject them out. It is possible, with practice, to carefully work the lever and capture the loaded ejected cartridges with your other hand.

THROUGHOUT THE UNLOADING

PROCESS MAKE SURE THAT THE SAFETY (MANUAL HAMMER STOP) STAYS IN THE "ON" POSITION (WITH THE "S" SHOWING) AND THAT YOU KEEP YOUR FINGER AWAY FROM THE TRIGGER AT ALL TIMES.

When cartridges no longer eject when you cycle the action, further assure that no cartridges remain by opening the action and visually checking the chamber and feed/magazine mechanism to be sure no cartridges remain.

IMPORTANT: ALWAYS VISUALLY NOTE, BY LOOKING THROUGH THE TOP OF THE OPEN RECEIVER, THAT THE MAGAZINE FOLLOWER IS SHOWING—AND NOT A CARTRIDGE BASE.

ALWAYS DOUBLE CHECK THAT NO CARTRIDGES REMAIN.

After the last live round is moved out of the magazine and ejected, immediately lower the hammer to the rebound position as explained previously.

FIRING

IMPORTANT: WHEN YOU ARE PREPARING TO SHOOT, IT IS ALWAYS ESSENTIAL THAT YOU BE TOTALLY SURE OF YOUR TARGET. ALWAYS BE AWARE OF ALL OBJECTS BEHIND YOUR TARGET. KNOW THE EXACT LOCATION OF PERSONS WITH YOU AND ANY OTHERS IN YOUR VICINITY. PICK YOUR TARGET WISELY AND CAREFULLY.

With a loaded cartridge in the chamber, **THE SAFETY (MANUAL HAMMER STOP) IN THE "ON" POSITION, THE HAMMER IN THE REBOUND POSITION AND YOUR FINGER OFF THE TRIGGER:**

FIGURE 13

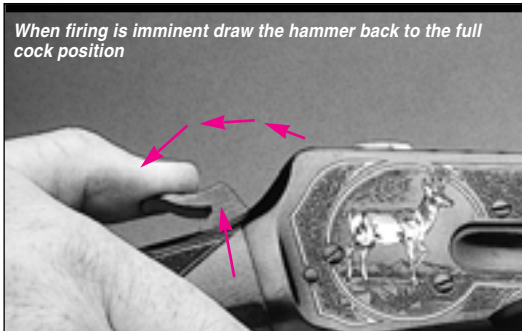

1. Firmly position your thumb on the hammer and draw the hammer back to the full-cock position (see Figure 13).
2. Place the safety in the “off” position by pushing it fully forward, covering the “S”.

CAUTION: YOUR RIFLE IS NOW READY TO FIRE. REMEMBER, THE RECOIL FROM A LARGE CALIBER CENTERFIRE RIFLE WILL BE SOMEWHAT HEAVY, SO FIRMLY SHOULDER YOUR GUN, TAKE AIM, AND — WHEN ON TARGET — SQUEEZE THE TRIGGER.

3. Firmly shoulder your gun, take aim and when on target squeeze the trigger smoothly, without jerking. After firing, let the trigger return to the fully forward position.

TO CONTINUE THE LOADING PROCESS AND CHAMBER ANOTHER ROUND FOR THE NEXT SHOT:

1. Swing the finger lever fully down extracting and ejecting the fired cartridge case from the chamber.
2. Close the action by returning the finger lever

upward. The closing of the action will transfer a new cartridge from the magazine to the chamber, leaving the hammer in a cocked “ready to fire” position. Start again at step #3 above or go immediately to step #6 below.

3. WHEN THROUGH FIRING ALWAYS IMMEDIATELY PLACE THE SAFETY (MANUAL HAMMER STOP) IN THE “ON” POSITION AND THE HAMMER IN THE REBOUND POSITION.

4. To later fire additional cartridges from the magazine —with an empty casing still in the chamber — simply work the finger lever downward fully ejecting the empty cartridge and then return the lever to the original upward position. Repeat the firing sequence again.

5. WHEN FIRING IS COMPLETED OR WHEN SHOOTING IS NO LONGER IMMINENT, IMMEDIATELY RETURN THE SAFETY (MANUAL HAMMER STOP) TO THE “ON” POSITION AND RETURN THE HAMMER TO THE REBOUND POSITION.

IMPORTANT: UNDER NO CIRCUMSTANCES SHOULD YOU MOVE ON OR CONTINUE TO HUNT WITH YOUR HAMMER OR SAFETY IN THE FIRE POSITION.

6. At this point you will need to either refill the magazine with loaded cartridges (if shooting is going to continue), or fully unload your rifle (if shooting is completed). Either way place the safety in the “on safe” position and the hammer in the rebound position.

IMPORTANT: ALWAYS KEEP YOUR MODEL 1892 SHOULDERED WHEN EJECTING AN EMPTY CARTRIDGE CASE. Ejection is up and slightly to the right. If you eject a cartridge with the rifle lowered and the action directly in front of your face, it is possible that the ejected cartridge could strike the shooter in the face. Caution should be taken by the shooter and bystanders behind the shooter. When an empty cartridge is correctly ejected it will fall to the ground in an area behind and to the right of the shooter.

IN THE CASE OF A MISFIRE

Only rarely will modern factory ammunition experience a misfire. If this ever happens to you when shooting your Model 92 please follow these instructions carefully.

CAUTION: IN CASE OF MISFIRE, KEEP THE BARREL POINTED IN A SAFE DIRECTION, PLACE THE MANUAL HAMMER STOP IN THE “ON” POSITION AND CAREFULLY OPEN ACTION WHILE AVOIDING DIRECT EXPOSURE TO THE BREECH BY YOURSELF AND OTHERS.

Carefully inspect the ejected cartridge. If the primer is indented, the cartridge should be disposed of in a manner that would prevent accidental injury to you or others. If there is no indentation, your gun has malfunctioned and should be serviced by a qualified gunsmith or by a U.S. Repeating Arms Company Authorized Repair Center (ARC).

It is important that you be fully familiar and totally competent with your rifle's handling and operation procedures. With the safety in the “on” position, it is

FIGURE 14

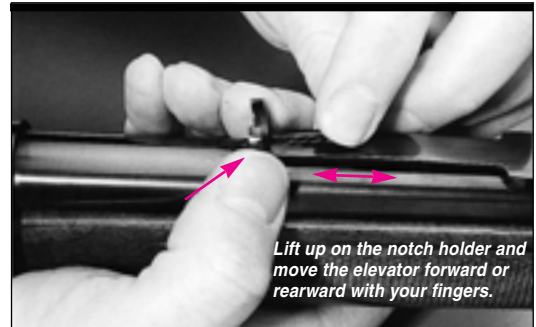

possible to cock the hammer and pull the trigger, and then, when the cartridge fails to fire, think the rifle has misfired. However, you may have merely forgotten to move the safety to the “off” position. In either case, always keep the muzzle pointed in a safe direction until you determine the cause.

SIGHT ADJUSTMENTS

Model 1892 rifles are fitted with traditional open sights.

OPEN STYLE SIGHTS

Your firearm can be adjusted to shoot higher by moving the rear sight elevator backward by one or more notches.

In order to shoot lower, the elevator can be moved forward (See Figure 14).

The rear sight is attached to the barrel in a dove-tailed slot machined into the barrel. By gently tapping the rear sight base (where fastened to the barrel) to the right, your gun will shoot more to the right.

FIGURE 15

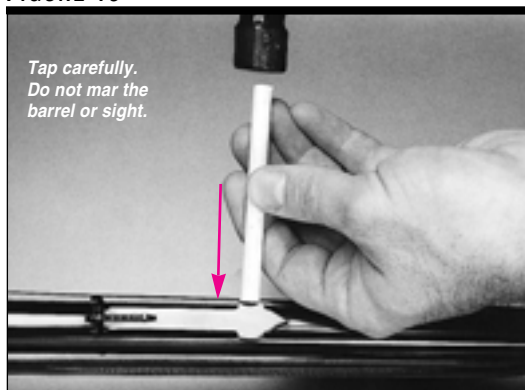

An adjustment to the left can be made by tapping the base to the left (See Figure 15).

Care should be taken not to mar the finish or bend sights when adjustments are made.

A NONMARRING BRASS, PLASTIC OR FIBER HAMMER AND/OR DRIFT IS ALWAYS PREFERRED FOR THIS OPERATION.

CLEANING AND MAINTENANCE SUGGESTIONS

The Model 1892 will function better and more reliably over a longer period of time if it is properly maintained and kept clean.

BEFORE PERFORMING ANY CLEANING PROCEDURES, ALWAYS MAKE CERTAIN THERE ARE NO CARTRIDGES IN THE CHAMBER, MAGAZINE OR ACTION/FEED AREAS.

You should clean your Model 1892 after every day of shooting and more often if it becomes excessively dirty. A minimum cleaning includes wiping down the

action and oiling key parts. Most regular maintenance will also include cleaning the barrel. If you encounter a function problem (tight action when working the finger lever), be sure to give your gun a thorough cleaning to see if it solves the problem before seeking the services of our service facility or a competent gunsmith.

To clean your firearm, follow the general outline below:

CLEANING PROCEDURES —

BE CERTAIN YOUR GUN'S CHAMBER AND MAGAZINE ARE UNLOADED. ALWAYS WEAR PROTECTIVE SAFETY GLASSES DURING ALL

KEEP AMMUNITION AWAY FROM THE CLEANING AREA. DO NOT TEST THE FUNCTION OF YOUR FIREARM WITH LIVE AMMUNITION.

ALWAYS PLACE THE SAFETY (MANUAL HAMMER STOP) IN THE "ON" (SAFE) POSITION BEFORE BEGINNING ANY CLEANING PROCEDURE.

1. Open the action. Use a cleaning rod with a tip and patch suitable for your caliber bore. Make sure the patch is large enough for a snug fit in the bore.

Insert the rod and patch into the barrel at the muzzle end and run it back and forth several times. **USE A CROWN PROTECTOR IF POSSIBLE.** Be careful not to strike the crown of the muzzle with the handle end of the rod. Damage to this area can affect the accuracy of the rifle.

2. Inspect the chamber and bore for brass, copper, lead and powder fouling. A normal amount of powder residue can be expected and is not serious. It can usu-

ally be removed by repeating step one, using a patch saturated with solvent. If or when fouling should become heavy, it can be removed with a brass bore brush. Dip or spray the brush with solvent and scrub the chamber and bore until the fouling is removed. To prevent brass bristles from breaking off, the brush should be pushed completely through the bore before being withdrawn.

3. After fouling has been removed the bore should be wiped dry. Then pass a slightly oiled patch through the bore, for preservation. A fine, light gun oil is recommended.

4. Wipe all exposed metal surfaces of the receiver, forearm and barrel with a clean rag. Finger marks should be removed because they provide a place where moisture can accumulate. Any dried oil in the receiver area should also be removed.

5. Then lightly oil your gun at the points described under “Oiling the Action” explained earlier in this manual. Ordinary good judgment will, of course, indicate that the metal of the gun should receive a light film of oil any time the rifle has been exposed to weather or handling. Remember, the polished, finely fitted surfaces of the receiver and action mechanisms must always have a thin film of oil. Make sure that the surfaces of the breech block, lever components and feed mechanism parts are especially clean and lightly oiled with a high quality gun oil. Do not use pure silicone or lanolin.

6. INSPECT THE BARREL AND CHAMBER. TO MAKE CERTAIN THAT NO PATCHES HAVE BEEN INADVERTENTLY LEFT IN THEM. Remove any that remain.

7. Wipe all wood surfaces.

8. When transporting only, place your Model 1892 in a quality protective case to prevent scratches and dents. Store in a dry place to prevent corrosion. Store away from children. Make sure your gun is unloaded and always store ammunition separately.

OTHER CLEANING SUGGESTIONS —

- Never pour large quantities of oil into the receiver or other parts. It can drain down to the wood and soften it — and cause permanent damage and loosening of the stock.
- After extended periods of heavy use, your gun should be taken to a qualified gunsmith to have the action disassembled for professional cleaning and lubrication.

NEVER ATTEMPT TO TAKE YOUR MODEL 1892 APART FURTHER THAN EXPLAINED IN THIS MANUAL.

This is a specialized, finely fitted mechanism. You may permanently mar it by attempting to disassemble the inner mechanism assemblies. If further disassembly for service or cleaning is required, take your gun to a U. S. Repeating Arms Company recommended Service Center or a competent gunsmith as explained under “Service or Repair.”

ORDERING PARTS

To order parts, please write our parts department and furnish the following: your name, address, and telephone number. Also specify the model and serial number of your gun. When we receive your request, we will send an order form and a parts breakdown with prices.

Write to:

Parts Department

U.S. Repeating Arms Company, Inc.

275 Winchester Avenue

New Haven, Connecticut 06511-1970

CAUTION: PARTS ARE MADE FOR WINCHESTER BRAND FIREARMS MANUFACTURED BY OR FOR U.S. REPEATING ARMS COMPANY, INC., AND SHOULD NOT BE USED IN OTHER GUNS EVEN THOUGH MODELS MAY BE SIMILAR. IMPROPERLY FITTED PARTS MAY BE DANGEROUS.

SERVICE OR REPAIR

If your Winchester firearm should ever need repair or service, please utilize one of the world-wide network of U.S. Repeating Arms Company Authorized Repair Centers for Winchester firearms. If you have any questions about how to obtain service for your Winchester firearm, call or write the Authorized Repair Center (ARC) nearest you. A list of ARCs is packaged with your new gun. If you need to obtain a new list of ARCs call us at:

1-203-789-5000

QUESTIONS

If you have other questions about Winchester rifles and shotguns, call or write our Customer Service Department:

Customer Service

U.S. Repeating Arms Company, Inc.

275 Winchester Avenue

Morgan, Utah 84050-9333

Phone: 1-800-945-5237

WINCHESTER-GUNS.COM

U.S. Repeating Arms Company offers an information resource for you on the world wide web.

- List of authorized repair centers.
- Customer service information.
- Answers to many technical and historical questions.
- Links to helpful sites.

Go to: www.winchester-guns.com